

Roadside Syntropic Planting Diagram

This Planting Diagram is designed to be implemented along roads commonly visited on foot and with easy vehicle access. The long-term and large production of coconut, pipa, jackfruit, and bananas require transport support to gather and redistribute the abundance, as well as intensive preparation and management. Grid Lines indicate 1 meter.

Row A

- A Mulberry hedge bordering the roadside rewards regular visitors
- Tall Chakuano Coconut alternate with Dwarf Pipas every 4 meters
- A pair of papaya are spaced @ 1.8 meters between the palms
- Ginger lines the edge away from the road
- An Annual mix of Pidgeon pea and Sesame fill the gaps

Row B

- A 1-meter-wide trail creates a 2-meter offset from the center lines of Rows A & B
- Biriba trees are spaced 6 meters, triangulated away from the Jackfruit of row C. Biribas will be phased out in 4-6 years.
- Bananas are planted densely, every 2 meters, between Biribas.
- Turmeric / Curcuma fills in between, alternating with the Annual mix of Pigeon Pea and Sesame
- Yuca and Mexican Sunflower line the edge away from the road

Row C

- A 2-meter spacing of pasture creates a 3-meter offset from the center lines of Rows B & C
- Jackfruit and Guaba/Ice-cream Bean alternate every 3 meters, with the Guaba serving primarily as a support specie
- Papaya and Banana alternate between the Jackfruit and Guaba trees
- An Annual mix of Pidgeon pea and Sesame edge the roadside half of the row
- Mexican Sunflower edges the opposite side

←-----15meters----->

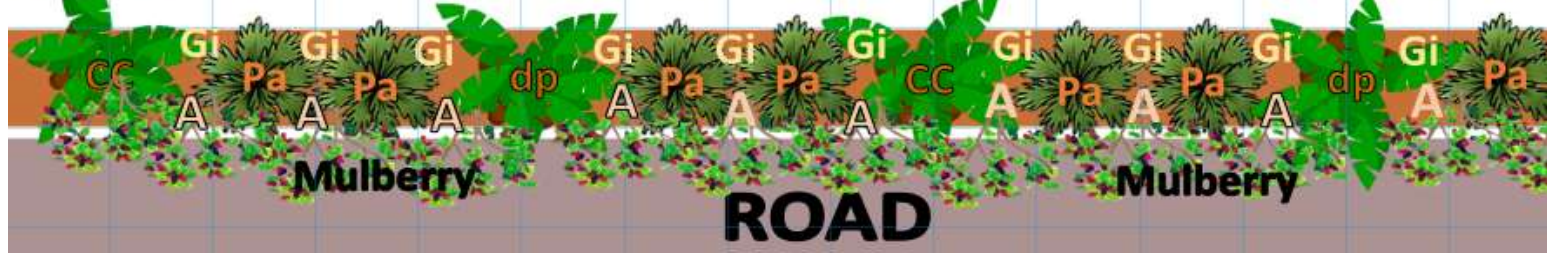

C

B

A



Ready to co-create?

Click [here](http://PermaVida.org/Regenesis) to get started:
PermaVida.org/Regenesis

Together, We Thrive!

